

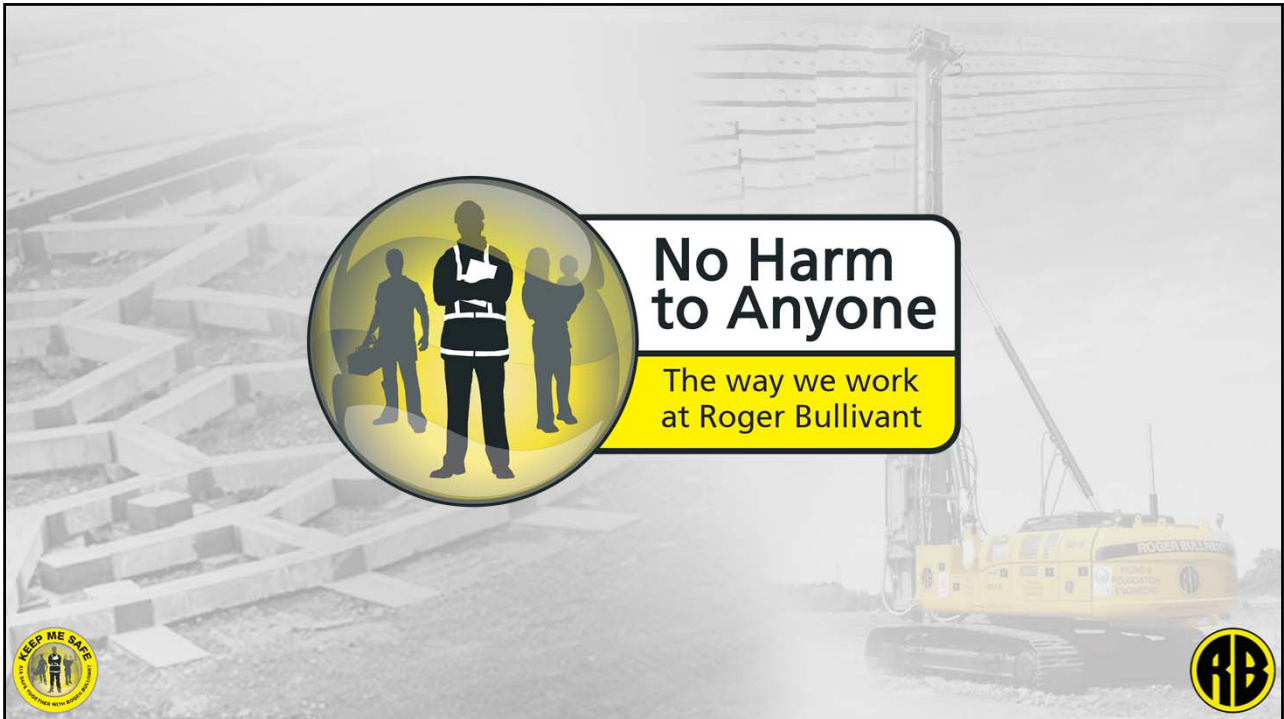





A construction site background featuring a large concrete foundation structure on the left and a yellow tracked drilling rig on the right. The scene is slightly hazy. Overlaid on the center is a yellow and black circular logo with 'RB' monogram and the text 'ROGER BULLIVANT' curved below it. Below the logo, a yellow horizontal bar contains the text 'Jordan Roberts' and 'Graduate Civil Engineer'. In the bottom left corner, there is a small circular safety logo with the text 'KEEP ME SAFE' and 'WORKING WITH RIGOR'. In the bottom right corner, there is a small version of the 'RB' logo.



## Business units and Area Offices

- Scotland
- North East
- North West
- Yorkshire
- Midlands
- South Wales
- South West
- South East

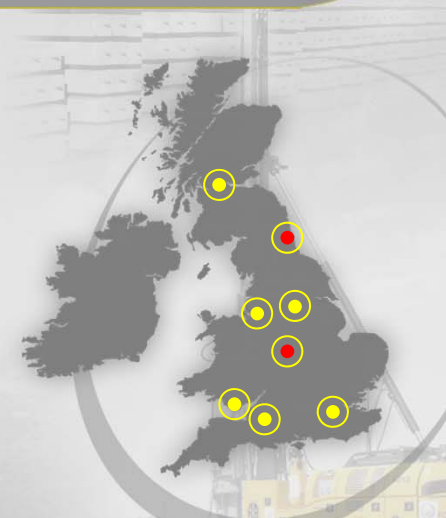

**CPRE** Campaign to Protect Rural England  
Working with you to protect the countryside

### FROM WASTED SPACE TO LIVING SPACES

The availability of brownfield land for housing development in England

University of the West of England, for the Campaign to Protect Rural England  
Dr Danielle Smeeth, Dr Laurence Carmichael, Professor Katie Williams, Paul Minor  
November 2014



## Key Findings

Councils have identified capacity for at least 1 million new homes on brownfield land.

Sites with existing planning permission can accommodate more than 405,000 homes.

Data shows that new brownfield sites replace ones that have already been redeveloped.

550,000 homes - located on suitable vacant or derelict land, including at least 146,000 in London.



Figure 2. Housing completions in the UK, by sector, 1919-2011 (Source: RTPI, 2013 reproduced from British Historical Statistics, Cambridge 1988 (1919-1948), DCLG (1949-2011) (note this figure is for the whole of the UK)

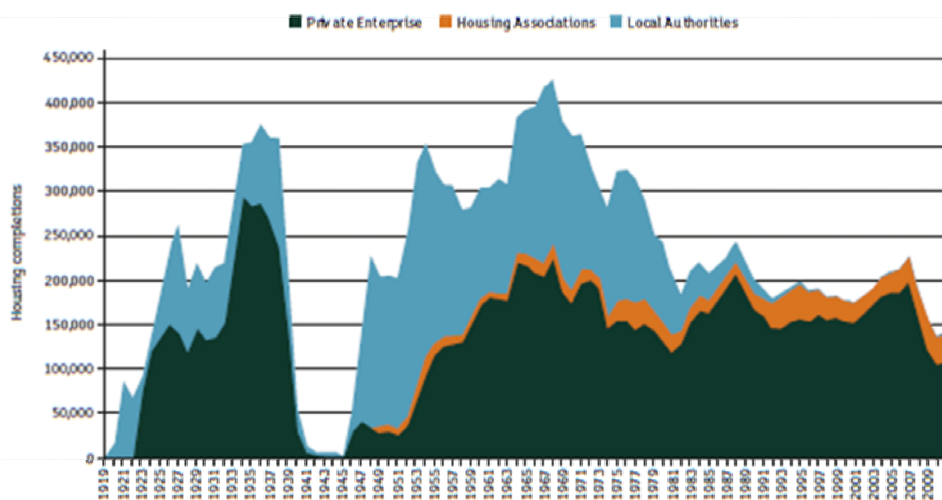

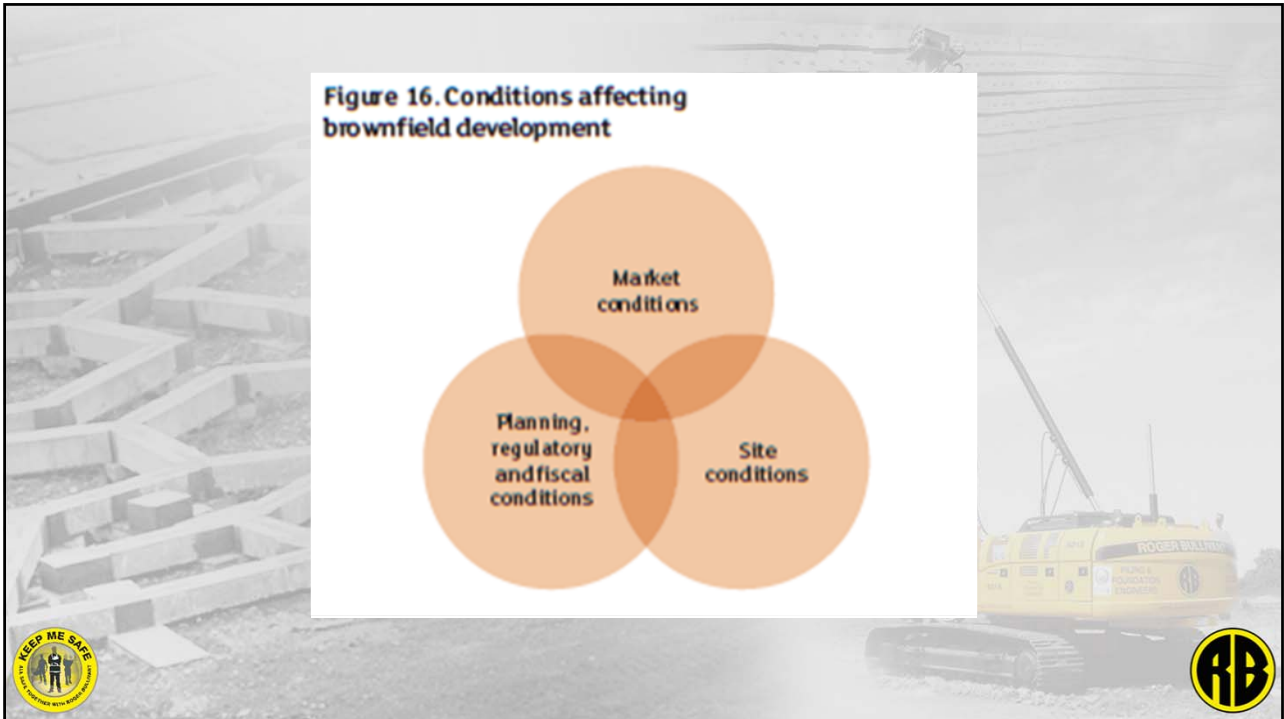

## Planning freedoms and more houses to buy

- Building more homes that people can afford to buy
- Releasing land for the homes people need
- A zonal system for brownfield land
- Ensuring planning decisions are made on time
- More devolved planning powers
- Starter Homes and Right to Buy
- Buy to Let

The right side of the slide features a document cover. At the top left is the HM Treasury logo. The main title is 'Fixing the foundations: Creating a more prosperous nation'. At the bottom left is the code 'Cm 9008' and at the bottom right is the date 'July 2015'. The background of the document cover shows a yellow excavator on a construction site.

**KEEP ME SAFE**  
SAFETY IS THE WAY TO SUCCESS

**RB**

# Precast Modular Foundations

Compliments piling system

Technical input from client

Floor, ground and drainage levels

Early meeting with Ops teams

Full setting out & checks include

Dedicated design teams



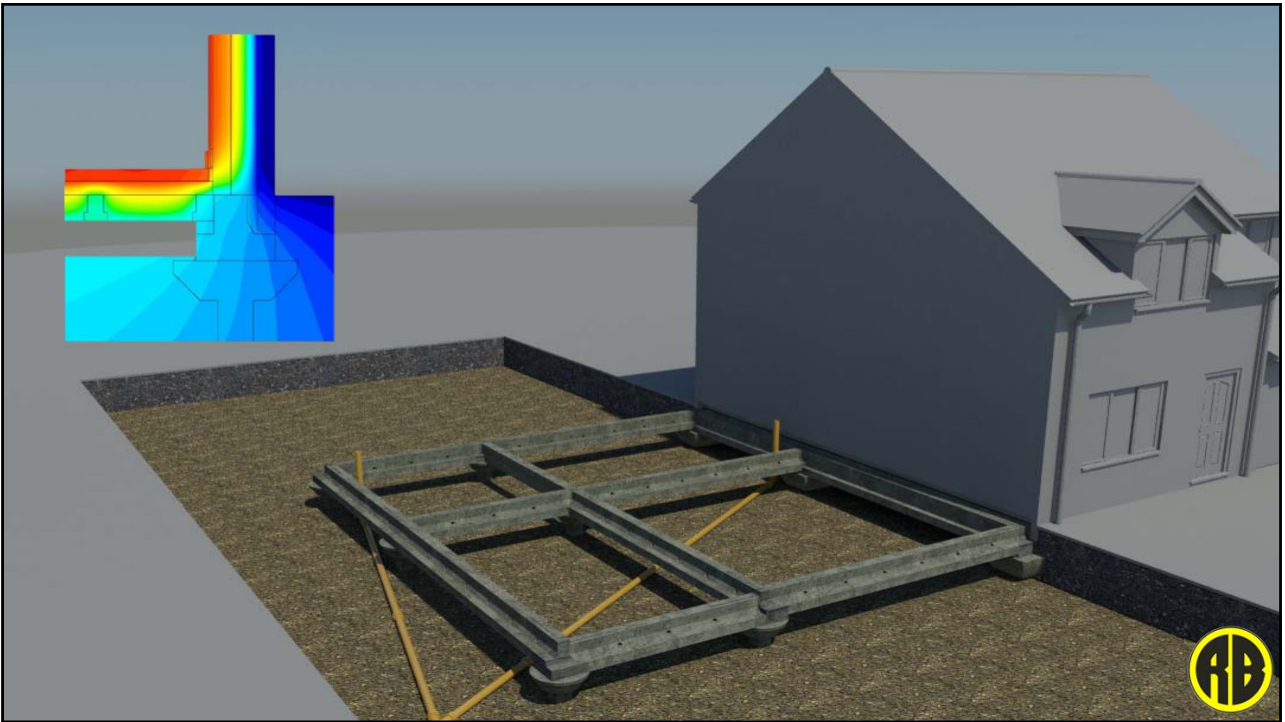
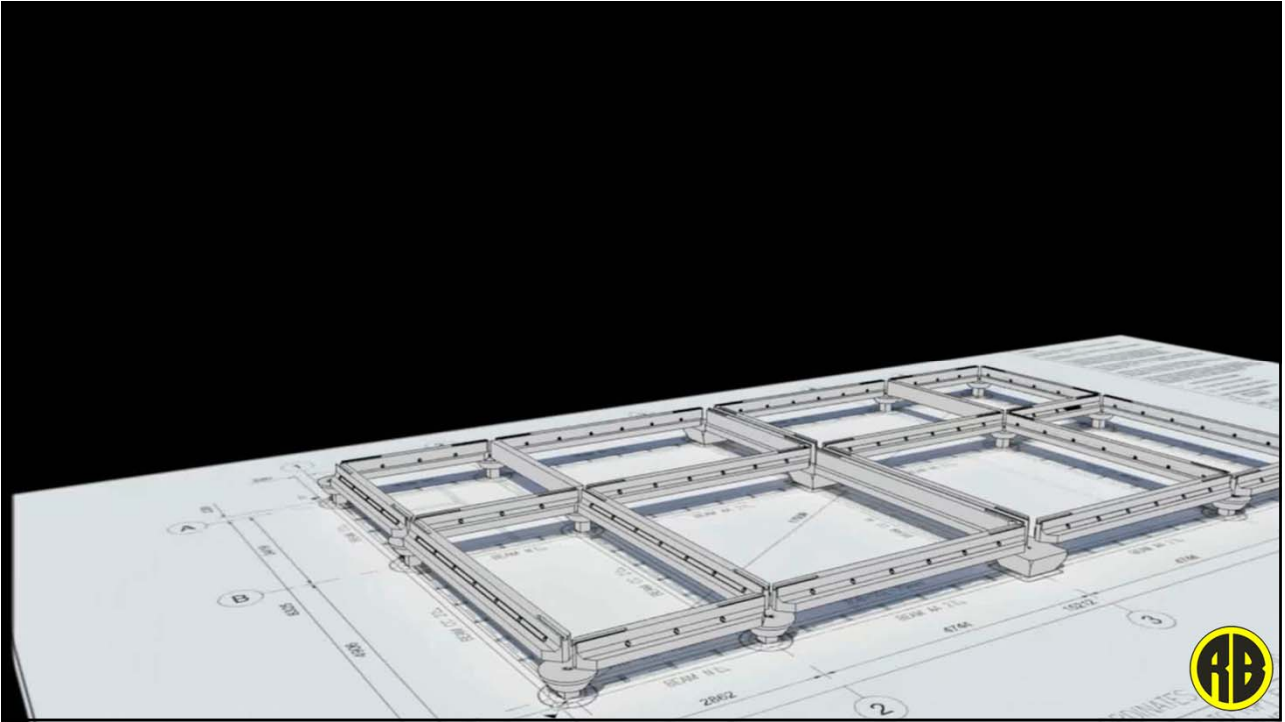

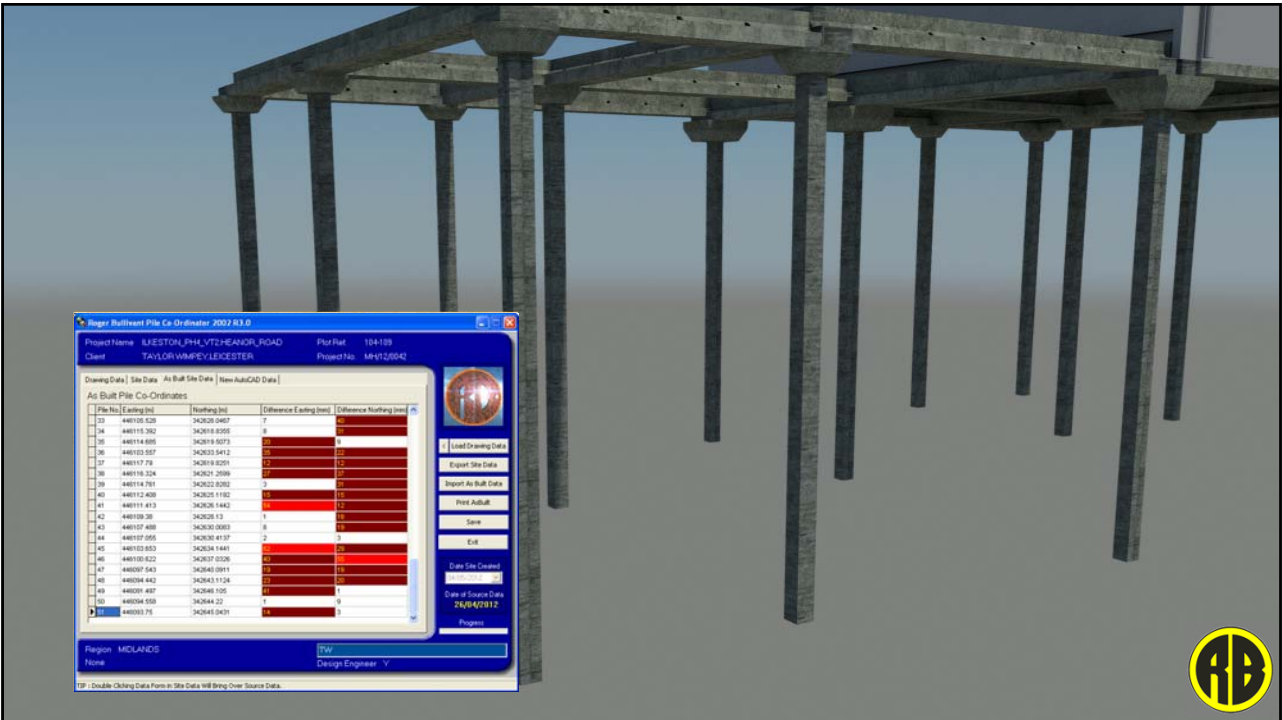
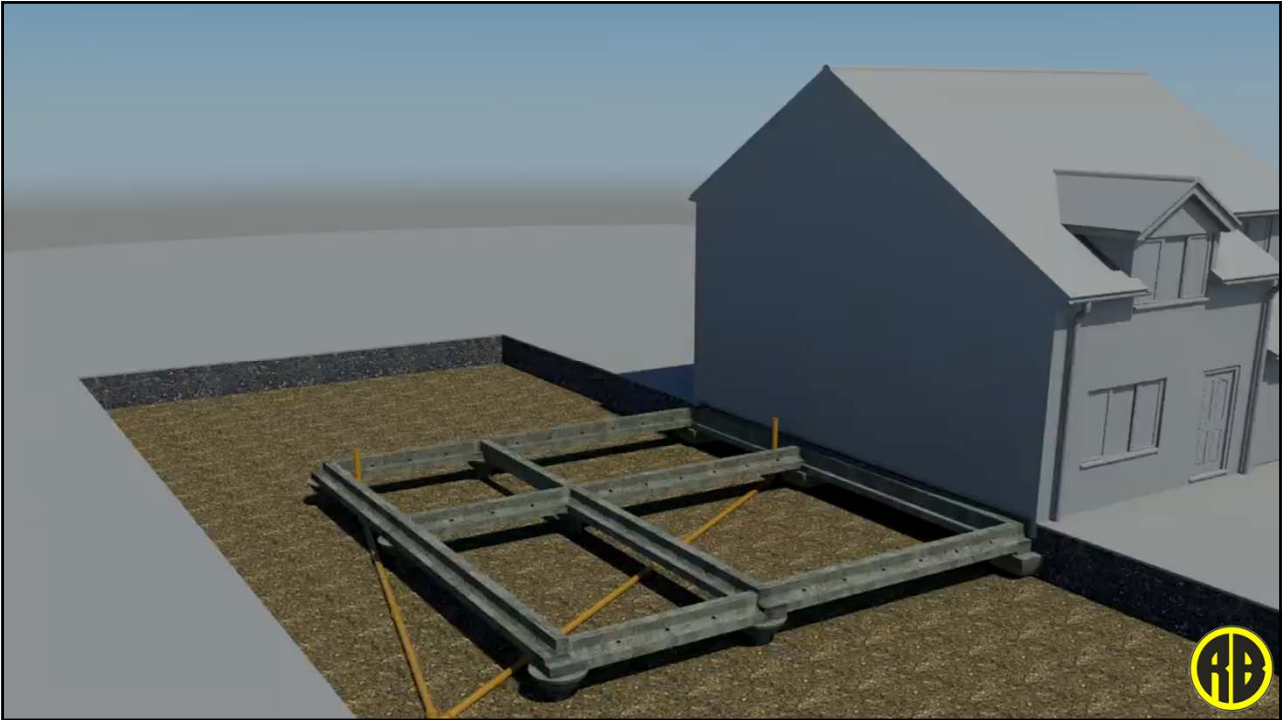



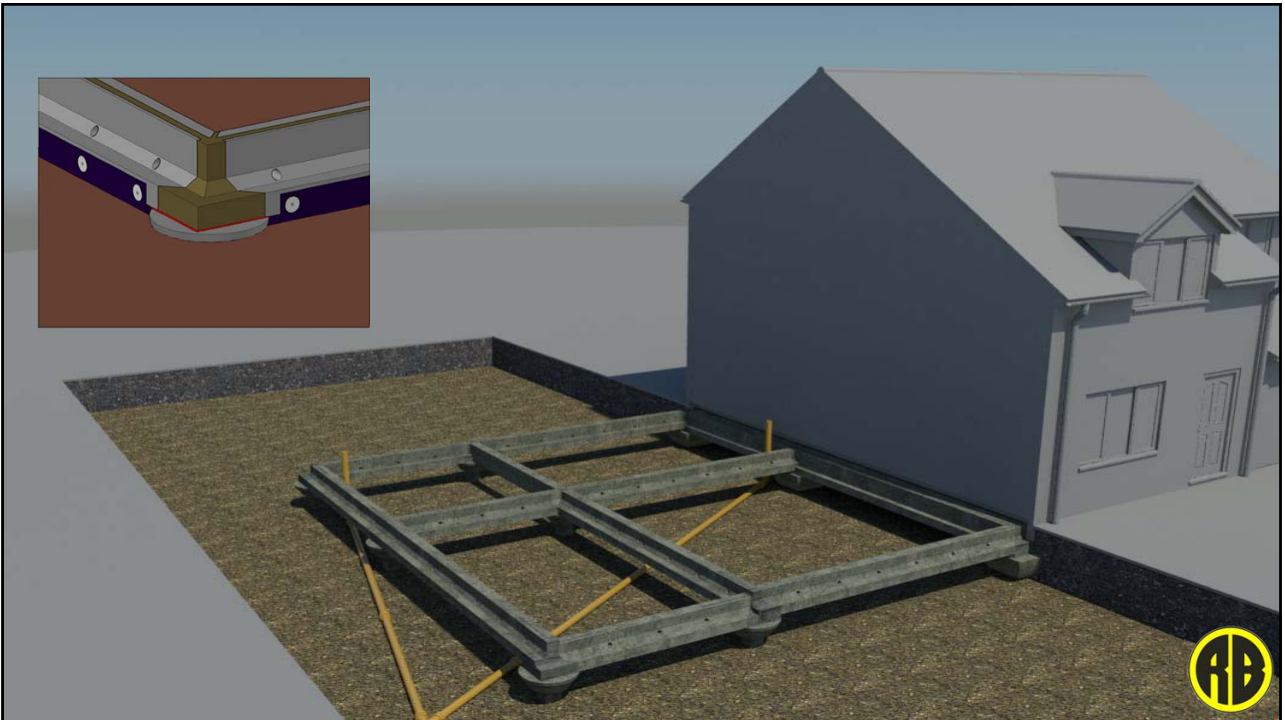
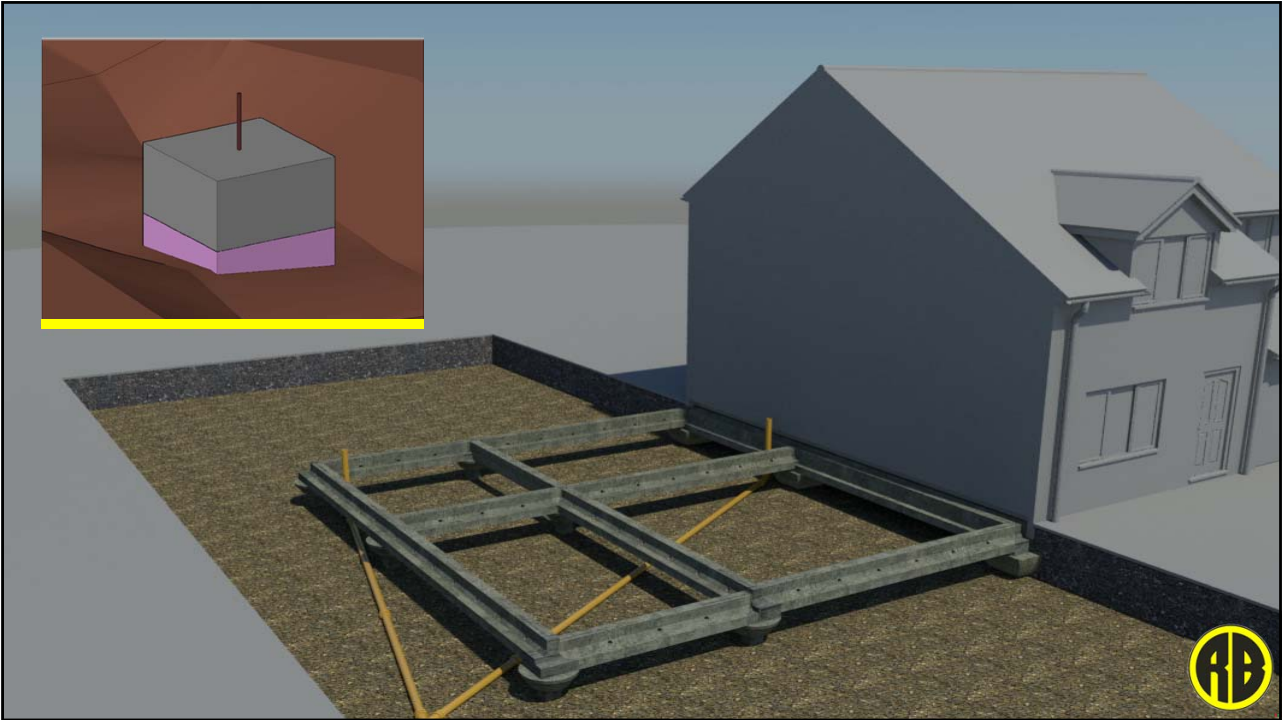

### Package - precast



### Hilton Mill, Derby



Hilton Mill, Derby



Hilton Mill, Derby



### Echovia Homes, Cheshire



### Echovia Homes, Cheshire



## Retirement Village, Birmingham

ExtraCare Retirement Village

Foundation Package

Multi discipline structure

2700 lm of ground beam

1000 concrete driven piles



## Retirement Village, Birmingham



## Retirement Village, Birmingham



## Rhodes Avenue Primary School, London



Rhodes Avenue Primary School, London



Rhodes Avenue Primary School, London



### Rhodes Avenue Primary School, London



### Ashford, Kent





Ashford, Kent



Displacement - Vibro Stone Columns



**ROGER BULLIVANT**

**GROUND IMPROVEMENT**



Displacement – Precast concrete piles



**ROGER BULLIVANT**

**PRE CAST DRIVEN PILING**



Displacement - CHD



**ROGER BULLIVANT**

**CHD PILING**



# Contact Us



@RogerBullivant



Roger Bullivant Limited



[www.roger-bullivant.co.uk](http://www.roger-bullivant.co.uk)



[info@roger-bullivant.co.uk](mailto:info@roger-bullivant.co.uk)



0845 838 1801

